



HiPace[®] 300

Compact yet powerful turbopumps with
pumping speeds of up to 260 l/s for N₂



HiFace® 300 with TC 400, DN 100 ISO-K

- Rugged, powerful turbopump with a pumping speed of up to 260 l/s for N₂
- Integrated TC 400 drive electronics
- Ideal for analytical and industrial applications
- For installation in any orientation
- With integrated water cooling for maximum gas throughput
- Flexible through the ability to employ up to 4 accessories
- Ideal for fast cycles
- Extensive accessories expand the range of applications

C=Corrosive gas version

Characteristics

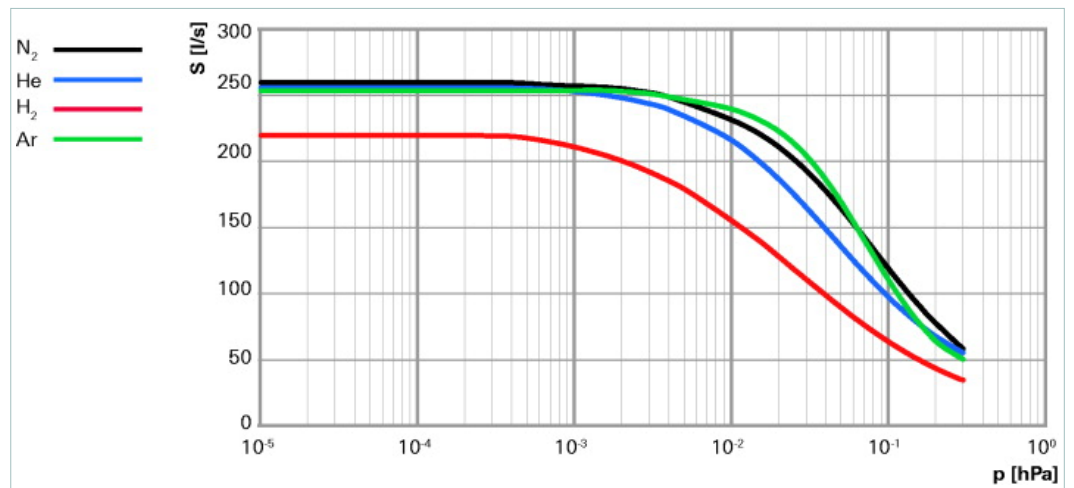

Dimensions

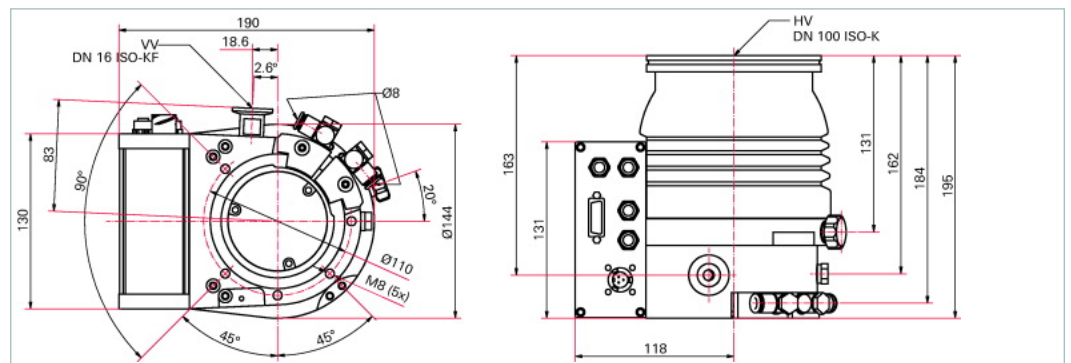

Technical Data	HiPace® 300 with TC 400, DN 100 ISO-K
Bearing	Hybrid
Compression ratio for Ar	$> 1 \cdot 10^{11}$
Compression ratio for H ₂	$9 \cdot 10^5$
Compression ratio for He	$> 1 \cdot 10^8$
Compression ratio for N ₂	$> 1 \cdot 10^{11}$
Cooling method, optional	Air
Cooling method, standard	Water
Cooling water consumption	50 l/h
Cooling water temperature	15-35 °C 59-95 °F 288-308 K
Electronic drive unit	with TC 400
Flange (in)	DN 100 ISO-K
Flange (out)	DN 16 ISO-KF / G 1/4"
Fore-vacuum max. for N ₂	20 hPa 15 Torr 20 mbar
Gas throughput at full rotational speed for Ar	7 hPa l/s 5.25 Torr l/s 7 mbar l/s
Gas throughput at full rotational speed for H ₂	> 14 hPa l/s > 10.5 Torr l/s > 14 mbar l/s
Gas throughput at full rotational speed for He	10 hPa l/s 7.5 Torr l/s 10 mbar l/s
Gas throughput at full rotational speed for N ₂	14 hPa l/s 10.5 Torr l/s 14 mbar l/s
Interfaces	RS-485, Remote
Mounting orientation	in any orientation
Operating voltage	24 (± 5 %) V DC
Permissible magnetic field max.	5.5 mT
Protection category	IP 54
Pumping speed for Ar	255 l/s
Pumping speed for H ₂	220 l/s
Pumping speed for He	255 l/s
Pumping speed for N ₂	260 l/s
Rotation speed ± 2 %	60000 min ⁻¹
Rotation speed variable	35-100 %
Run-up time	1.8 min
Sound pressure level	≤ 50 dB (A)
Ultimate pressure according to PNEUROP	$< 1 \cdot 10^{-7}$ hPa $< 7.5 \cdot 10^{-8}$ Torr $< 1 \cdot 10^{-7}$ mbar
Venting connection	G 1/8"
Weight	6.7 kg 14.77 lb

Order number	
HiPace® 300	PMP03900

Accessories	
Adapter and power switching components	
Connector M12 to RS-485	PM061270-X
Backing pump control	
Backing pump relay box, single phase 20 A, for TC 400 and TCP 350, M12 plug	PM061375-T
Control cable for pumping stations 0.7 m	PM061675AT
HiPace - ACP connection cable	PM071142-X
Relay box, shielded, for backing pumps, 1-phase 7 A for TC 400/1200, TM 700 and TCP 350, M12	PM071284-X
TVV 001 fore-vacuum safety valve, 115 V AC	PMZ01206
TVV 001 fore-vacuum safety valve, 230 V AC	PMZ01205
Cooling accessories	
Air cooling for HiPace 300, 115 V	PMZ01308
Air cooling for HiPace 300, 230 V	PMZ01309
Air cooling for HiPace 300 with TC 400	PMZ01302
General accessories	
Centering ring, with multifunction coating and integrated splinter shield, DN 100 ISO-K/-F	PM016807-U
Centering ring with multifunction coating, DN 100 ISO-K/-F	PM016210-U
Centering ring with multifunction coating and integrated protection screen, DN 100 ISO-K/-F	PM016212-U
Centering ring with multifunction coating and integrated splinter shield, DN 100 ISO-K/-F	PM016211-U
Extension cable M12 on M12	PM061747-T
Interface cable, M12 m straight/ M12 m angled 0.7 m	PM061791-T
Interface cable, M12 m straight / M12 m straight, 3 m	PM061283-T
Interface cable, plug M12, RJ 45, 3 m	PM051726-T
Mains power socket, angled, for TC 400/TM 700	P4723101
Mains power socket TC 400/TM 700, straight	P4723100
Remote adapter for RS-485	PM061649-X
Sealing gas throttle for HiPace 300/400/700 and 800	PMZ01317
Sealing gas valve, shielded for HiPace 300/400/700 and 800 with TC 400 and TM 700	PMZ01312
TIC 001, Interface converter RS-232/RS-485	PM051054-T
USB converter to RS-485 interface	PM061207-T
Vibration damper for HiPace 300/400, DN 100 ISO-K/F	PM006459-X
Y-connector, shielded, M12 for accessories	P4723013
Y-Connector M12 to RS-485	P4723010
Mains cables and connection cables	
Connection cable for HiPace with TC 400/TM 700 to power supply TPS/DCU 310/311/400/401	PM061352-T
Mains cable 115 V AC, NEMA 5-15 to C13, 3 m	P4564309ZE
Mains cable 208 V AC, NEMA 6-15 to C13, 3 m	P4564309ZF
Mains cable 230 V AC, CEE 7/7 to C13, 3 m	P4564309ZA
Mounting materials	
Mounting kit for HiPace 300, DN 100 ISO-K, including coated centering ring, protection screen and bracket screws	PM016367-T
Mounting kit for HiPace 300, DN 100 ISO-K, including coated centering ring, splinter shield and bracket screws	PM016366-T
Mounting kit for HiPace 300 with DN 100 ISO-K, including coated centering ring and bracket screws	PM016365-T

Accessories	
Power supplies and control displays	
Accessories package for HPU - Power supply, software and PC cable	PM061005-T
DCU 002, Display control unit	PM061348-T
DCU 310, Display control unit incl. power supply	PMC01822
Front panel kit for TPS 311	PM061395-T
HPU 001, handheld programming unit	PM051510-T
TPS 310, mains pack for wall/standard rail fitting	PM061342-T
TPS 311, mains pack 19" rack module 3HU	PM061346-T
Wall rail fitting TPS 110/180/310/400	PM061392-T
Venting accessories	
Banjo fitting, big	PM016787-T
Banjo fitting, small	PM143877-T
Hose nozzle for 9 mm hose, G 1/8"	PM016783-T
Plug-in connection for 6 mm hose, G 1/8"	PM016781-T
Plug-in connection for 8 mm hose, G 1/8"	PM016782-T
Power failure venting valve, shielded, 24 V DC, G 1/8" for connection to TC 400, TM 700 and TC 1200	PMZ01331
Screw-in flange, DN 10 KF, G 1/8"	PM033737-T
Screw-on flange, DN 16 ISO-KF, G 1/8"	PM016780-T
TTV 001, air drier for venting turbopumps	PMZ00121
Venting valve, shielded, 24 V DC, G 1/8", for connecting to TC 400,1200 and TM 700 with twisted plug 270°	PMZ01292
Venting valve, shielded, 24 V DC, G 1/8", for connection to TC 400/1200 and TM 700	PMZ01291

**Vacuum solutions
from a single source**

Pfeiffer Vacuum stands for innovative and custom vacuum solutions worldwide, technological perfection, competent advice and reliable service.

**Complete range
of products**

From a single component to complex systems:
We are the only supplier of vacuum technology
that provides a complete product portfolio.

**Competence in
theory and practice**

Benefit from our know-how and our portfolio of training
opportunities! We support you with your plant layout
and provide first-class on-site service worldwide.

**Are you looking for a
perfect vacuum solution?
Please contact us:**

Pfeiffer Vacuum GmbH
Headquarters · Germany
T +49 6441 802-0
info@pfeiffer-vacuum.de
www.pfeiffer-vacuum.com